

## Notes

© This drawing is the copyright of White Design (UK) Ltd. and cannot be reproduced in any form without express consent of the company. Written dimensions to be checked on site and discrepancies are to be reported prior to commencing work on site. Figured dimensions only are to be taken from this drawing. Do not scale. If in doubt ask.

### SAFETY, HEALTH AND ENVIRONMENTAL INFORMATION

IN ADDITION TO THE HAZARDS/RISKS NORMALLY ASSOCIATED WITH THE TYPES OF WORK DETAILED ON THIS DRAWING, NOTE THE FOLLOWING:

#### CONSTRUCTION

n/a

#### MAINTENANCE / CLEANING

n/a

#### DECOMMISSIONING / DEMOLITION

n/a

IT IS ASSUMED THAT ALL WORKS WILL BE CARRIED OUT BY A COMPETENT CONTRACTOR WORKING, WHERE APPROPRIATE, TO AN APPROVED METHOD STATEMENT

This drawing is a feasibility sketch only and no design assessment has been undertaken at this stage for a CDM Coordinator. It is based on topographical survey by HHH Surveys Ltd - drawing no. WC/313/SP dated 7.11.14 and O.S. Plan information. Licence No. 100020449 and is subject to ground investigation, confirmation of all boundaries (ownership) and all Statutory approvals. Position of all existing services to be confirmed on site prior to construction.

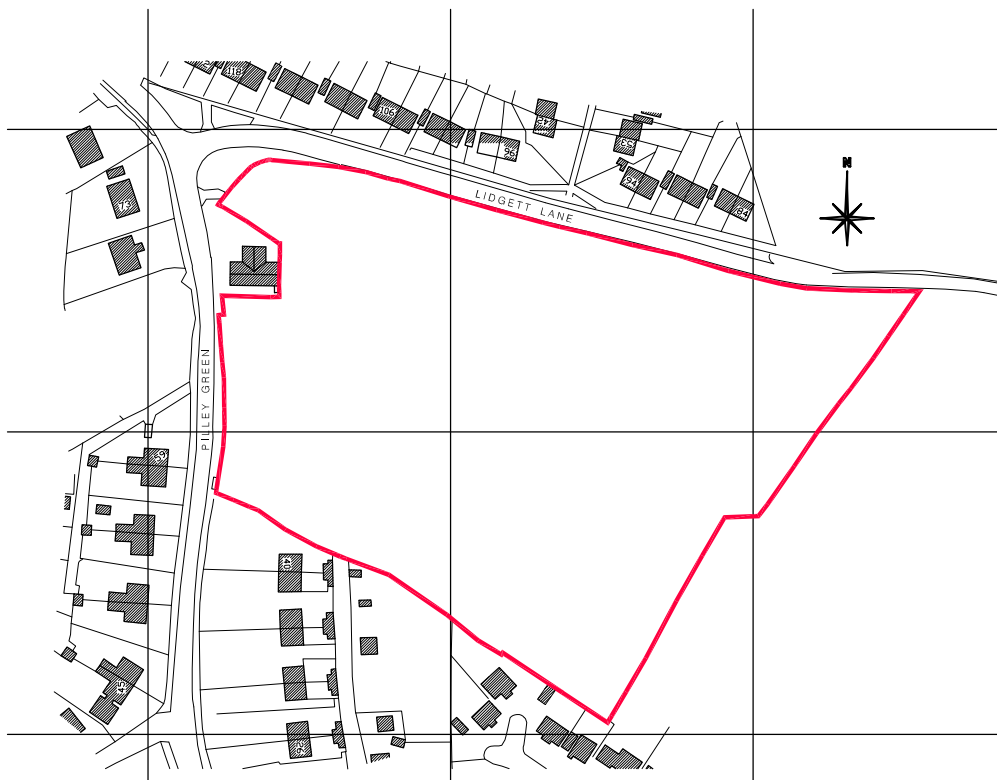

Rev: Date: Drawn: Description: Checked:

**White Design** 

Client: The Wortley Group

Project: Residential Development off Lidgett Lane, Pilley Green and New Road, Pilley

Title: Site Location Plan

Scales: 1:2500 @ A4 Drawn by: mb Date: Jan 2015

Drawing no: 0125/14/02/01 Rev: - Checked: ..

24a St. Andrew's Road, Sheffield, S11 9AL  
T: 0114 226 0255 F: 0114 226 0254  
E: office@whitedg.co.uk W: www.whitedg.co.uk

PLANNING