

Existing offsite Category B tree group (G21) to be retained and pruned away from proposed building in-line with BS 3998:2010 Tree Work Recommendations

Existing onsite Category C tree group (G22) to be removed

Uncategorised scrub vegetation to be removed

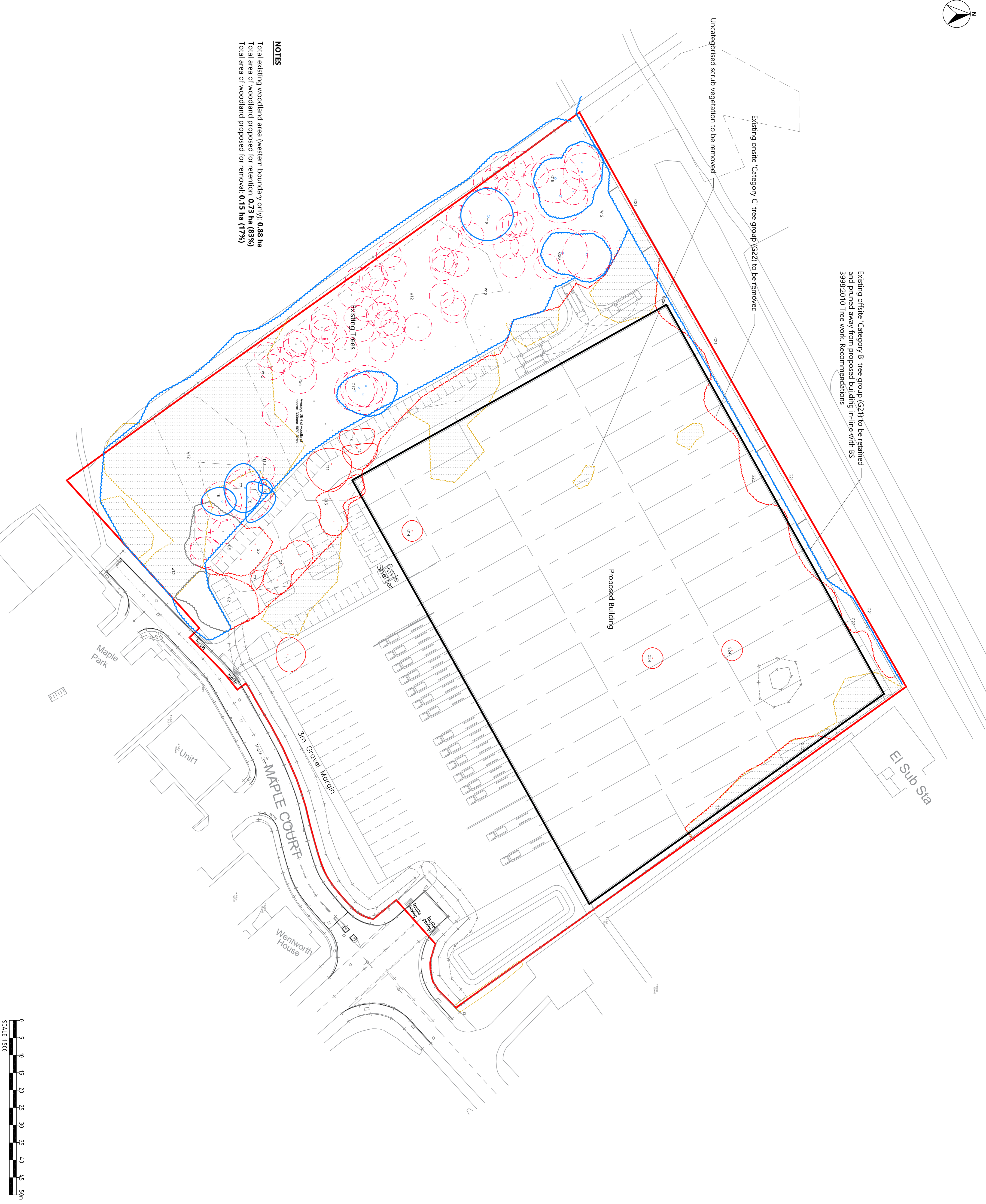

NOTES

Total existing woodland area (western boundary only): 0.88 ha
Total area of woodland proposed for retention: 0.73 ha (83%)
Total area of woodland proposed for removal: 0.15 ha (17%)

KEY

Site Boundary

Retention Category

Category B tree to be Retained

Category C tree to be Retained

Existing Trees to be Removed

UNCATEGORISED VEGETATION

As defined by topographical survey or estimated on site

Area of Existing TPO

TREE SURVEY NOTES

In accordance with BS5837:2012, trees in relation to Design, Development & Construction, other trees were surveyed and recorded. The original of this drawing is provided to client, a photocopy may provide not be able open. This drawing is the property of the surveyor and shall remain confidential to the client. The survey was conducted in accordance with BS5837:2012. The survey was conducted in accordance with BS5837:2012. The survey was conducted in accordance with BS5837:2012.

THE PRESERVATION ORDER (TPO)

The TPO is in place to protect the amenity, safety and health of the trees in the area. The TPO is in place to protect the amenity, safety and health of the trees in the area. The TPO is in place to protect the amenity, safety and health of the trees in the area. The TPO is in place to protect the amenity, safety and health of the trees in the area. The TPO is in place to protect the amenity, safety and health of the trees in the area.

NOTES

1. THIS DRAWING IS TO BE READ IN CONJUNCTION WITH ALL OTHER RELEVANT DOCUMENTATION.
2. THIS DRAWING IS TO BE READ IN CONJUNCTION WITH THE PROJECT HEALTH & SAFETY FILE FOR ANY AND ALL RELEVANT DOCUMENTATION.
3. THIS DRAWING IS TO BE READ IN CONJUNCTION WITH THE PROJECT HEALTH & SAFETY FILE FOR ANY AND ALL RELEVANT DOCUMENTATION.
4. THIS DRAWING IS TO BE READ IN CONJUNCTION WITH THE PROJECT HEALTH & SAFETY FILE FOR ANY AND ALL RELEVANT DOCUMENTATION.

STATUS: **DRAFT**
BASE: BWS Draw MFT-BWB-00-ZZ-DR-0-001
JOB REFERENCE: SK 33499Z
PROJECT: Maple Court, Tisbury
TITLE: Tree Removal Plan
CLIENT: Company Shop and Rala Developments Ltd
DATE: 10/01/17 SCALE: 1:500(0A1)
DRAWN: JC DRAWING NO: S0104-DR-488-104
CHECKED: MT REVISION: A

Surface Property
Chartered Landscape Architects
Environmental Consultants
1C Sainsbury Court East
York, YO1 6AQ
Tel: 01904 483 770
www.surfaceproperty.co.uk
SCALE 1:500
0 5 10 15 20 25 30 35 40 45 50m