

**NOTES:**

1. REFER TO DRAWING NUMBER B14264/D102 FOR MANHOLE SCHEDULES
2. REFER TO DRAWING NUMBER B14264/D103 FOR DRAINAGE DETAILS & NOTES

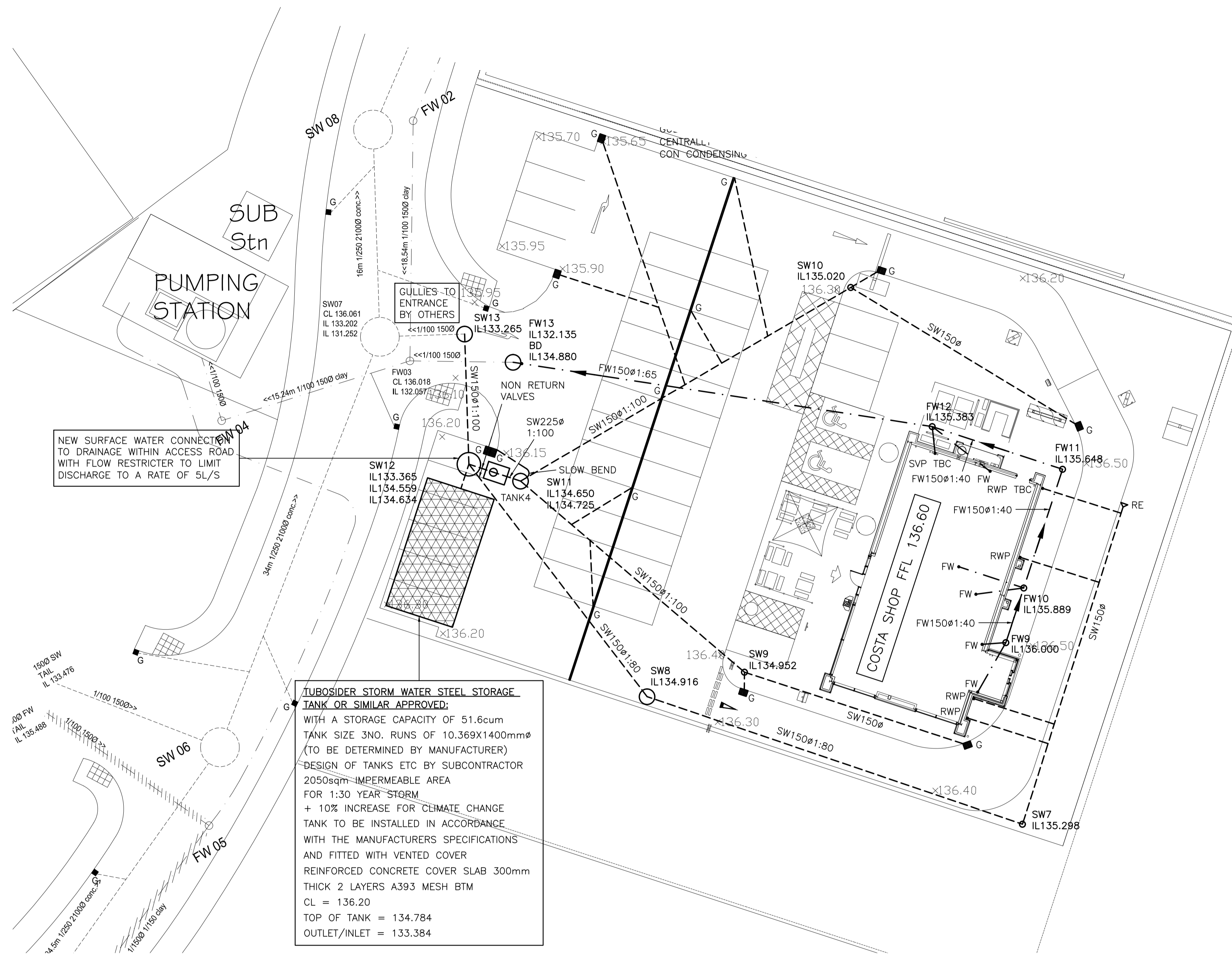

NEW SURFACE WATER CONNECTION TO DRAINAGE WITHIN ACCESS ROAD WITH FLOW RESTRICTOR TO LIMIT DISCHARGE TO A RATE OF 5L/S

**TUBESIDER STORM WATER STEEL STORAGE TANK OR SIMILAR APPROVED:**  
 WITH A STORAGE CAPACITY OF 51.6cum  
 TANK SIZE 3NO. RUNS OF 10.369X1400mmφ (TO BE DETERMINED BY MANUFACTURER)  
 DESIGN OF TANKS ETC BY SUBCONTRACTOR  
 2050sqm IMPERMEABLE AREA  
 FOR 1:30 YEAR STORM  
 + 10% INCREASE FOR CLIMATE CHANGE  
 TANK TO BE INSTALLED IN ACCORDANCE WITH THE MANUFACTURERS SPECIFICATIONS AND FITTED WITH VENTED COVER  
 REINFORCED CONCRETE COVER SLAB 300mm THICK 2 LAYERS A393 MESH BTM  
 CL = 136.20  
 TOP OF TANK = 134.784  
 OUTLET/INLET = 133.384

**TANK 4**  
 NEW BYPASS CLASS 1 SEPARATOR WITH COALESCING FILTER, AUTOMATIC CLOSURE, ALARM & POLLUTANT LEVEL MONITOR. DRAINED AREA 1770sqm APPROX TANK SIZE 1700X1350mmφ [TO BE DETERMINED BY MANUFACTURER] TANK TO BE INSTALLED STRICTLY IN ACCORDANCE WITH THE MANUFACTURERS RECOMMENDATIONS PROVIDE VENT PIPE AND STACK, POSITION TO BE AGREED REINFORCED CONCRETE COVER SLAB 2700X2400X300mm THICK TWO LAYERS A393 MESH BOTTOM  
 CL = 136.150  
 INLET = 134.628  
 OUTLET = 134.578

ACO S100/200 DRAINAGE CHANNELS AS NOTED TO CENTRAL FORECOURT SURROUND OR SIMILAR APPROVED WITH IN BUILT FALLS AND TRAPPED RODDABLE GULLIES & F900 HEELGUARD GRATE ALL INSTALLED IN ACCORDANCE WITH THE MANUFACTURERS RECOMMENDED DETAILS & SPEC

ALL GULLIES AT RWP LOCATIONS ARE TO HAVE RODDING ACCESS

ALL EXTERNAL DOORS WITH A LEVEL ACCESS TO HAVE A THRESHOLD DRAIN

CONNECTIONS INTO PUBLIC SEWERS TO BE IN ACCORDANCE WITH REQUIREMENTS OF LOCAL AUTHORITY

ALL INTERNAL DRAINAGE RUNS ARE DIAGRAMATIC & CAN BE ADJUSTED TO SUIT

ALL INTERNAL SVP'S TO HAVE RODDING ACCESS POINT

REFER TO ARCHITECTS DRAWINGS FOR LOCATION OF ALL SANITARY FITTINGS, SVP'S & RWP'S

**KEY**

- RWP RAIN WATER PIPE
- ▶ RE RODDING EYE
- G GULLY
- SVP SOIL VENTILATION PIPE
- BD BACK DROP
- SURFACE WATER DRAIN
- - - - - FOUL WATER DRAIN
- · — · — COMBINED WATER DRAIN

ARRANGEMENT SUBJECT TO FINAL LEVELS

PRELIMINARY

PI	NO.	DATE	ADDED	IL	REVISED	SW	DISCHARGE	RATE	S.P.M.
rev	date	revisions	initials						

client  
**THE KAY GROUP**

project  
**DEARNE VALLEY WAY  
 DEARNE VALLEY  
 YORKSHIRE**

drawing  
**COSTA SHOP  
 DRAINAGE LAYOUT**

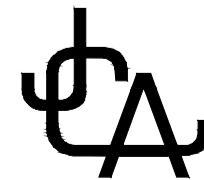
 **James Crosbie Associates Ltd**  
 Consulting Civil & Structural Engineers  
 37 Chorley New Road, Bolton, BL1 4QR  
 Telephone 01204 384585  
 Facsimile 01204 363358  
 Email jca@james-crosbie.co.uk

drawn	SPM	date	12.04.17
scale	1:200	checked	
contract no.	B14264	drawing no.	D101 P1